

## 830nm SMD Laser Module

### Features

150mW output power after DOE lens  
 High quality Random pattern DOE  
 3535 SMD package

### Absolute maximum ratings

Parameter	Symbol	Rating	Unit
Laser Module Optical Output Power	P <sub>o</sub>	150	mW
Reverse Voltage (LD)	VRL	0	V
Operation Case Temperature	TC	-10~50	°C
Storage Temperature	T <sub>s</sub>	-40~85	°C



### Electrical and optical characteristics (T<sub>c</sub>=25 °C)

Parameter	Symbol	Min.	Typ.	Max.	Unit	Conditions
Wavelength	$\lambda$	820	830	840	nm	P <sub>o</sub> =150mW
Threshold Current	I <sub>th</sub>	-	65	100	mA	
Operation Current	I <sub>op</sub>		260	330	mA	P <sub>o</sub> =150mW
Operation Voltage	V <sub>op</sub>		2	2.4	Volt	P <sub>o</sub> =150mW
Random Dot				>10,000		
Field Of View				(H) 80°x(V)60°		
Image Ratio				4:3		

\* Sufficient heat dissipation is required for CW operation.

### Outline dimensions (Units: mm)

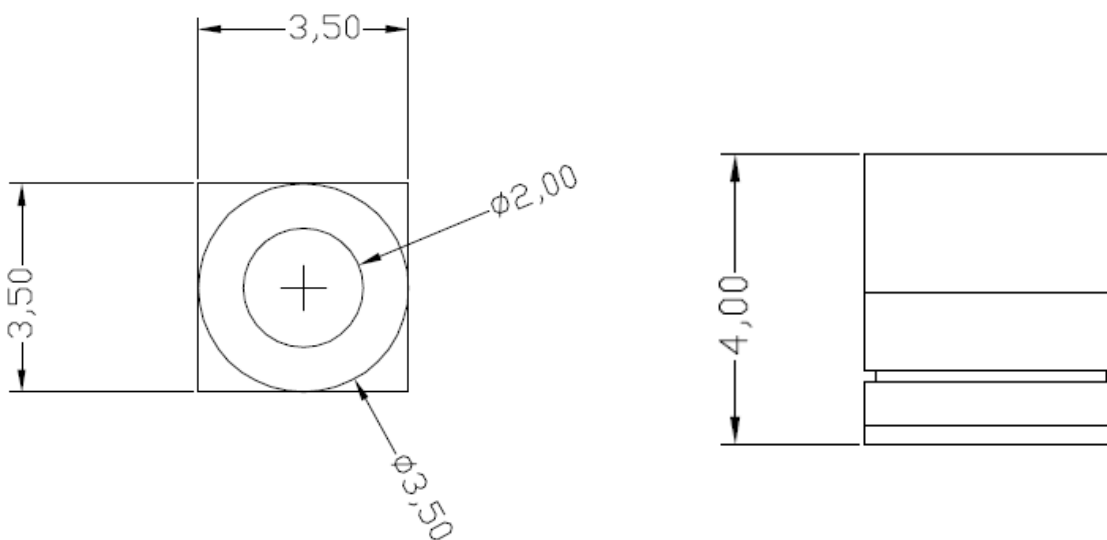

## 830nm SMD Laser Module

PIN Assignment:

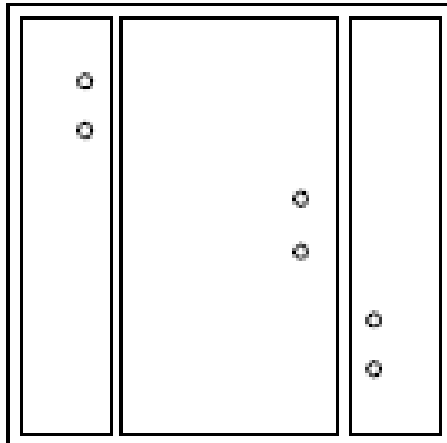

1

2

3

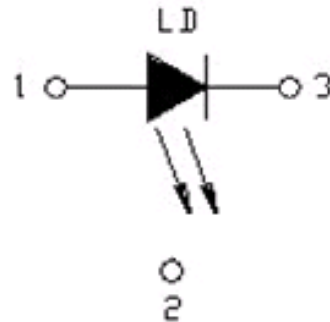

### ● Precautions

- \* Do not operate the device above maximum ratings. Doing so may cause unexpected and permanent damage to the device.
- \* Take precautions to avoid electrostatic discharge and/or momentary power spikes. A change in the characteristics of the laser or premature failure may result.
- \* Proper heat sinking of the device assures stability and lifetime. Always ensure that maximum operating temperatures are not exceeded.
- \* Observing visible or invisible laser beams with the human eye directly, or indirectly, can cause permanent damage. Use a camera to observe the laser.
- \* No laser device should be used in any application or situation where life or property is at risk in event of device failure.
- \* Specifications are subject to change without notice. Ensure that you have the latest specification by contacting us prior to purchase or use of the product.

### ARIMA LASERS CORP.

PHONE: 886-3-4699800 | FAX: 886-3-4699600

E-MAIL: [Ldsales@arimalasers.com](mailto:Ldsales@arimalasers.com) | [www.arimalasers.com](http://www.arimalasers.com)

*For reference only. Contents above are subject to change without notice.*